

Pecos River MRS Planning Booklet

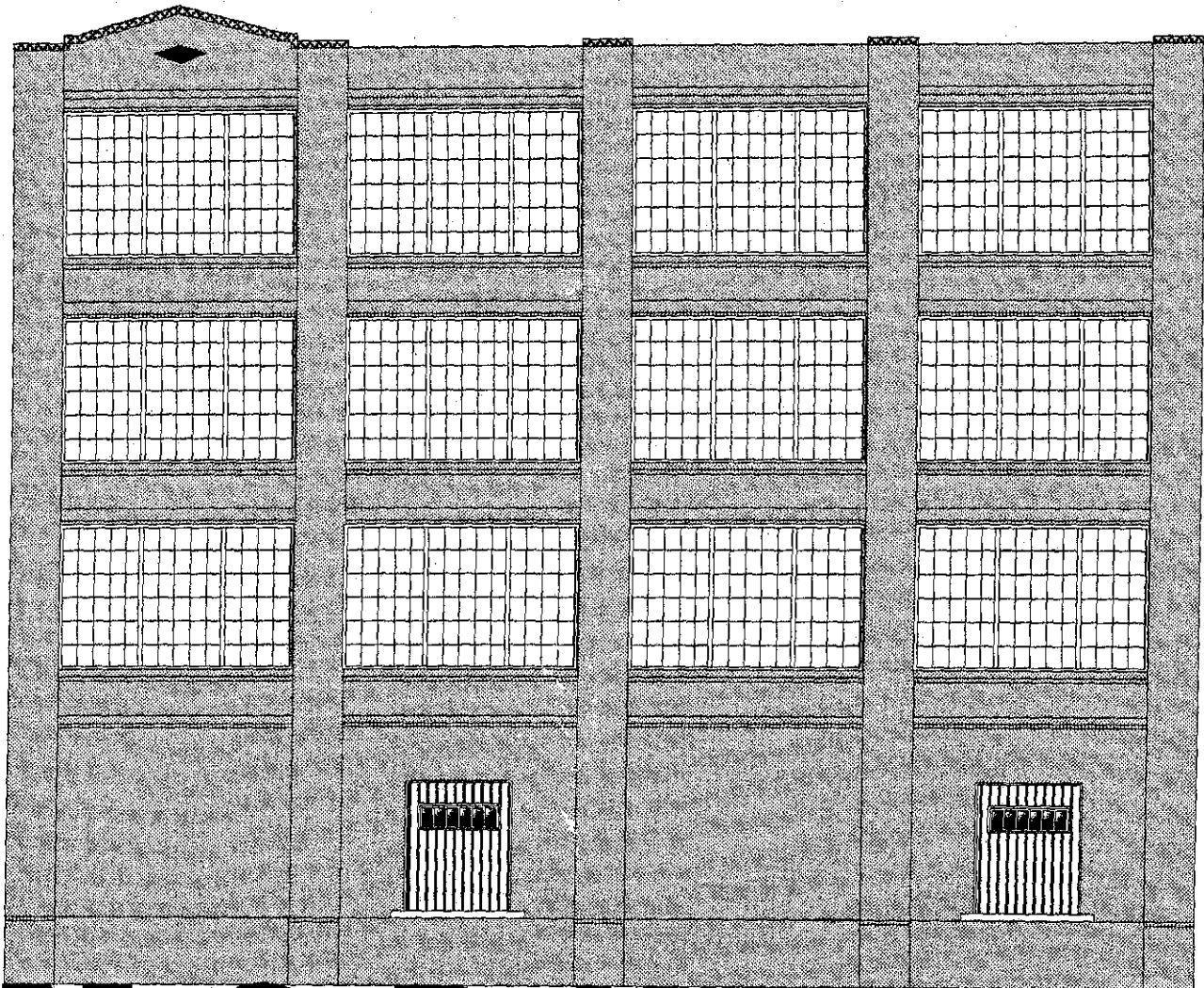

MODULAR RAILROAD STRUCTURES

CREATED BY RUSS BRIGGS DESIGNS, LLC

Now Produced by John C. Smith, Pecos River Brass

290 W. Lake Park Rd. #810, Lewisville, TX 75057 john@pecosriverbrass.com

Building Components

Part No. 200 Window Wall Section (2)

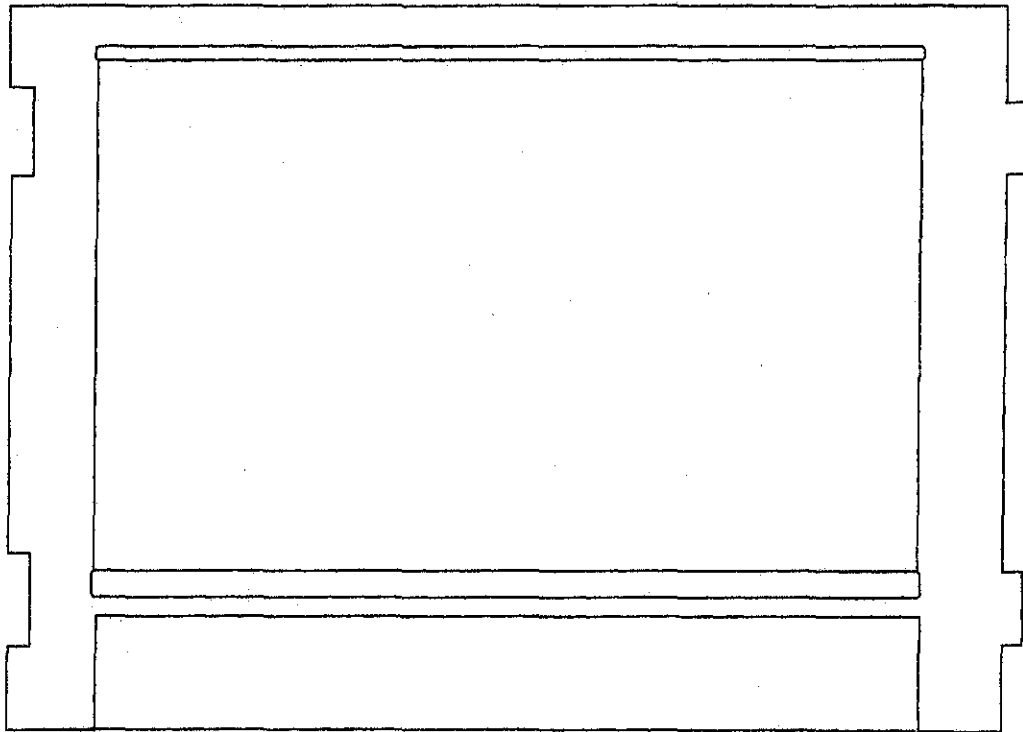

Part No. 201 medium/charcoal grey Window Insert (2)

Part No. 202 reddish-brown Window Insert (2)

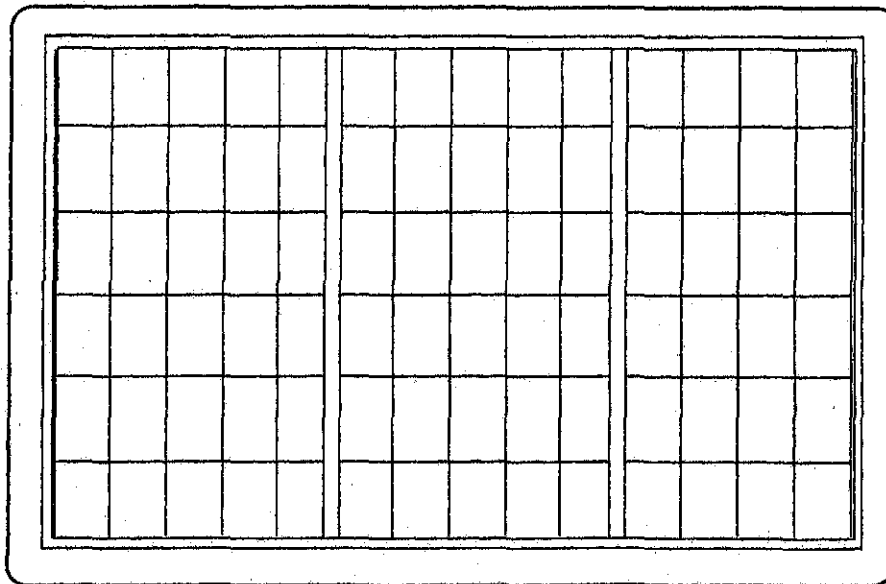

Building Components

Part No. 400 Blank Wall Section (2)

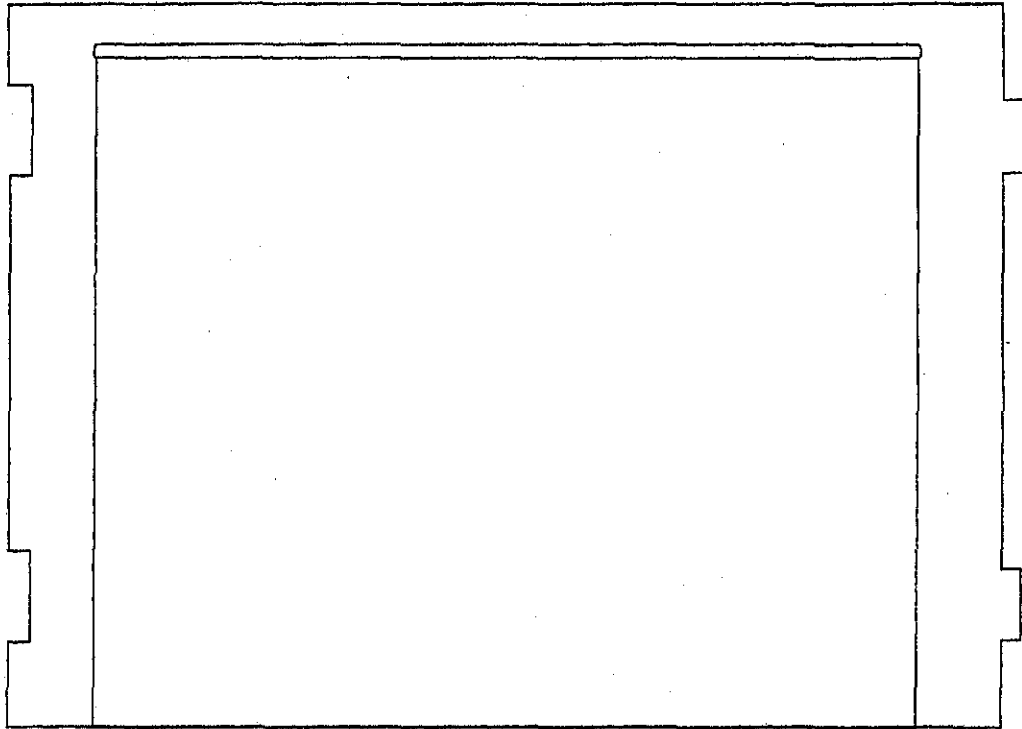

Part No. 300 Loading/Double Entry Dorr Wall Section (2)

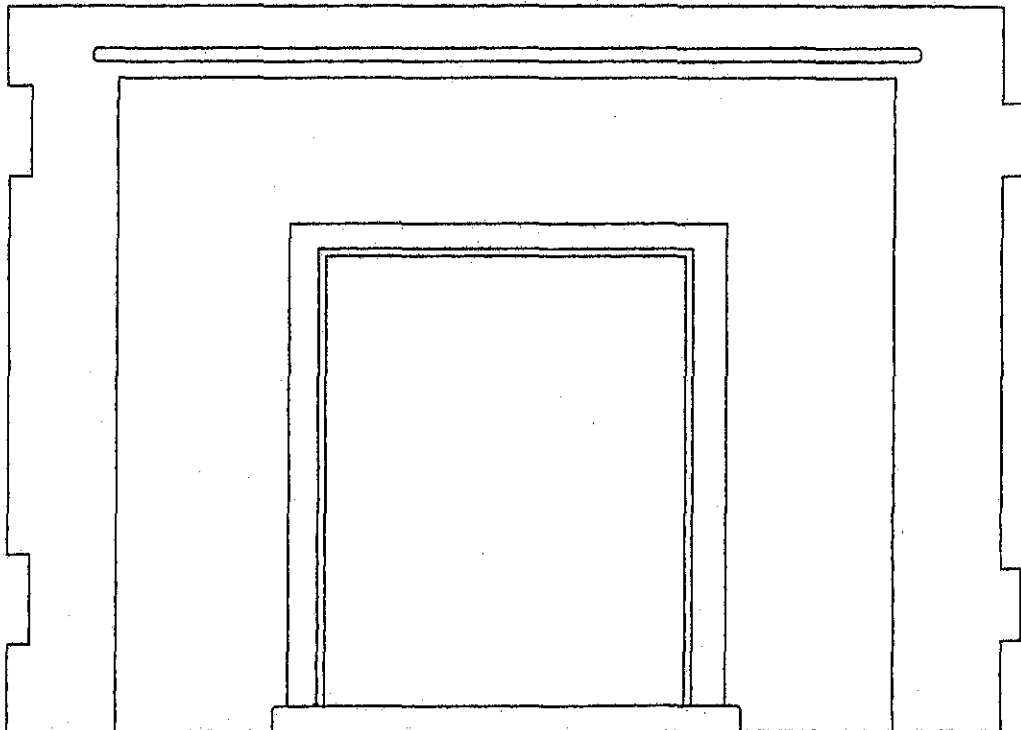

Building Components-Pilasters

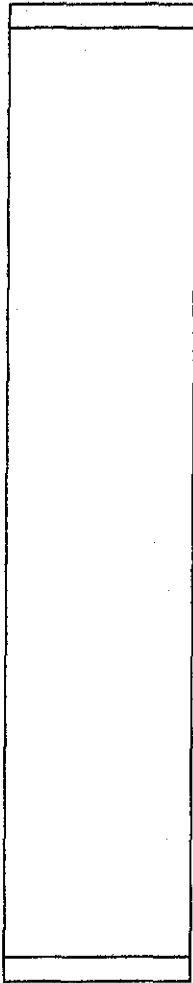

**Part No.
701
Top Middle
(Pair)**

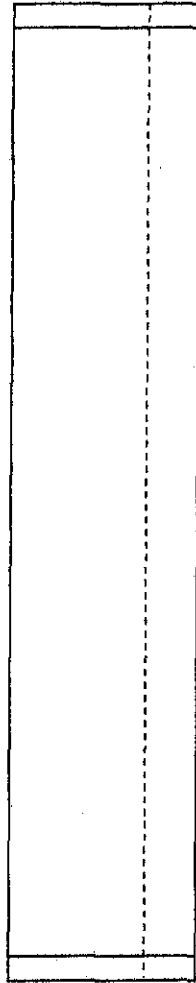

**Part No.
700
Top Corner
(Pair)**

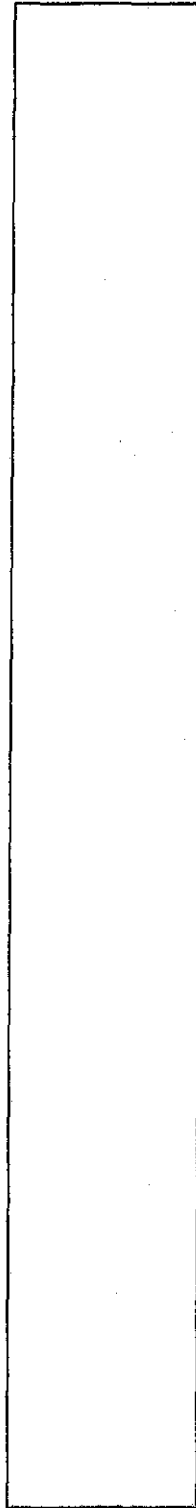

**Part No.
704
Middle Straight
(Pair)**

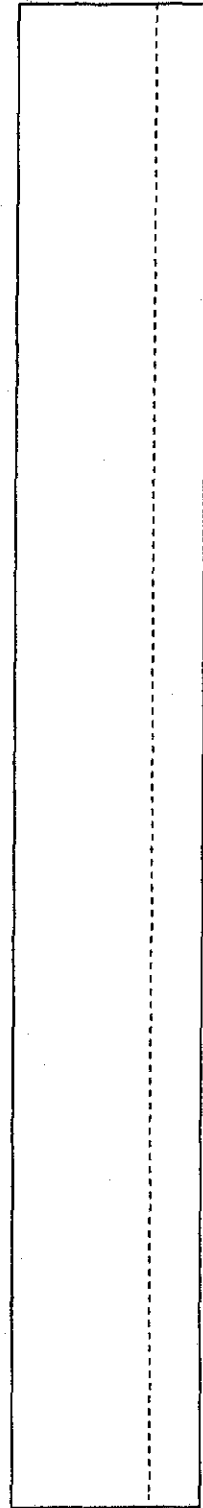

**Part No.
701
Middle Corner
(Pair)**

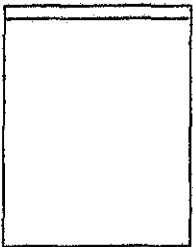

**Part No.
705
Middle Foundation
(Pair)**

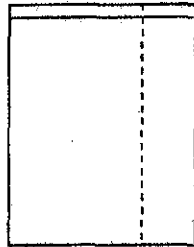

**Part No.
702
Corner Foundation
(Pair, L&R)**

Building Components

Part No. 100
Peaked Top (2)

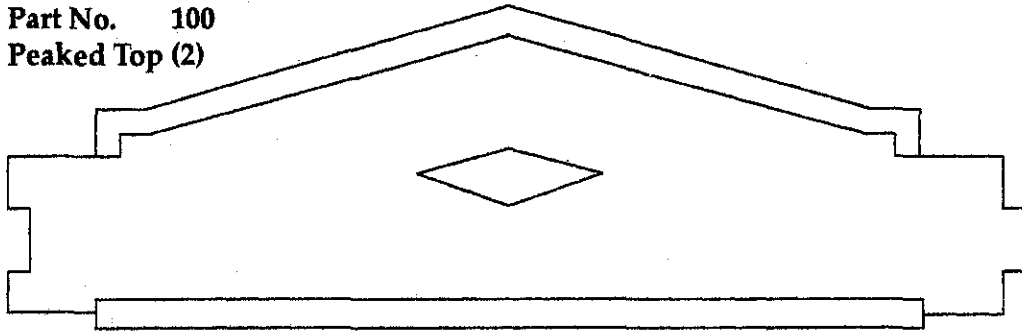

Part No. 101
Straight Top (2)

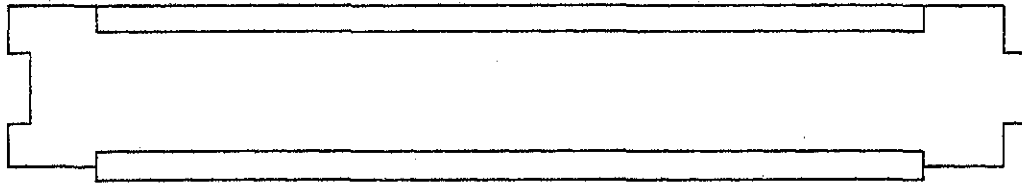

Part No. 500
Foundation for Blank Wall (2)

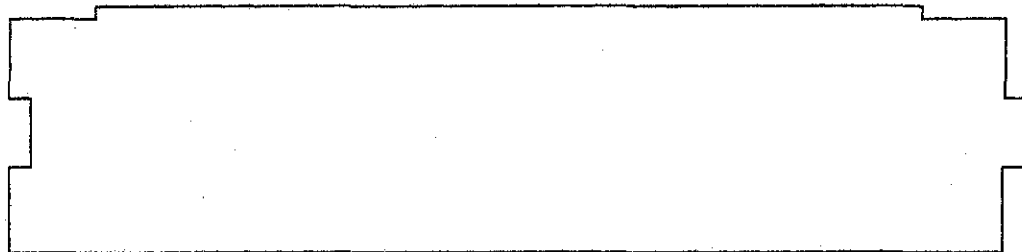

Part No. 501
Foundation for Loading/Entry Doorway Wall (2)

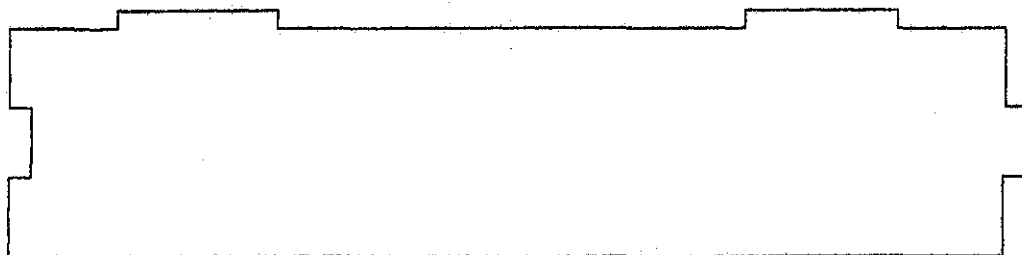

Building Component Templates Showing Middle Floors & Pilasters

Part No.

200

Part No.

201/202

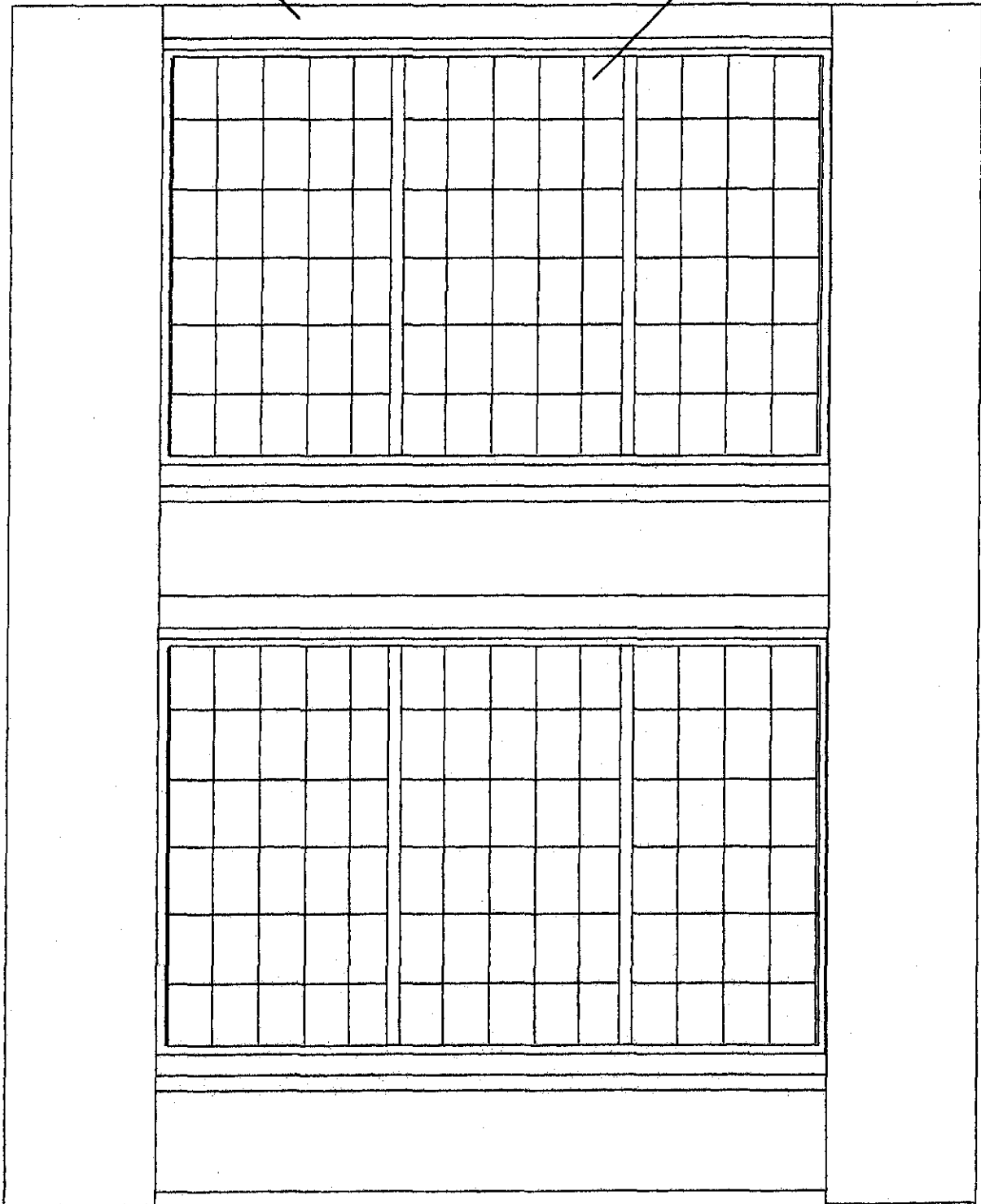

**Building Component Templates Showing Summer Street Freight Terminal
Showing 1-Bay with Building Top, Doorway Wall, Foundation & Pilaster**

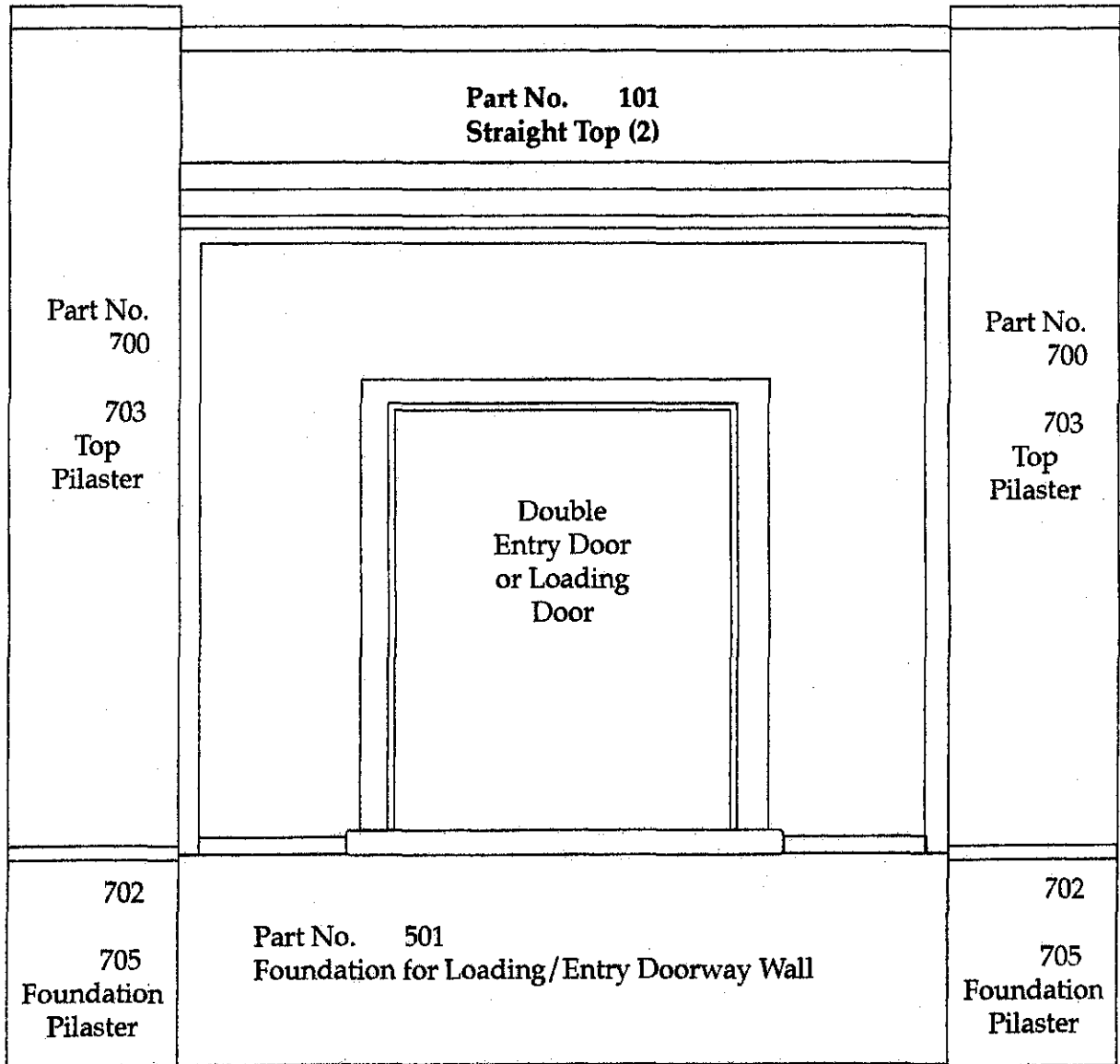

Building Component Templates Showing Top Floors, Building Top & Pilasters

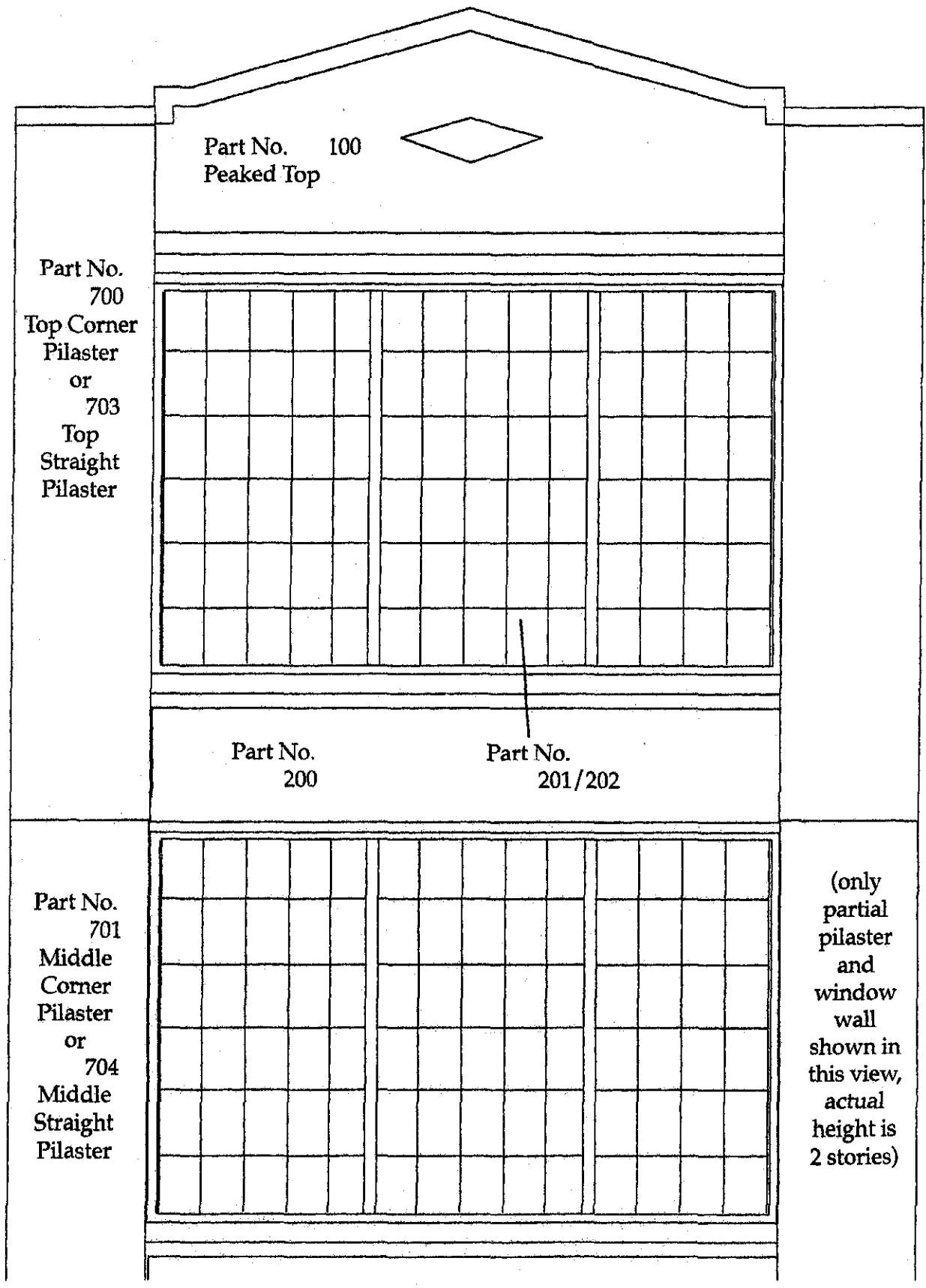

Building Component Template Showing Foundation, 1st & 2nd Floors, Pilasters

